

REVISIONS				
REV.	ECO. NO	DESCRIPTION	DATE	BY
C	964	UPDATE NOTES	03/23/06	MNH
D	1019	DWG. UPDATED TO 'HH' TERMINATION ONLY	05/10/2006	HT
E	1759	CORRECT MODEL VIEW TO HH TERMINATION TYPE (WAS HL), ϕ .100" HOLE FOR GUIDE POSTS ON PCB WAS ϕ .095", UPDATE NOTE 8, 9 & 11, ADD STEP TO ϕ .078" GUIDE POST, TABULATE R, G, A, J MTL OPTIONS	7/17/2008	IA/JH

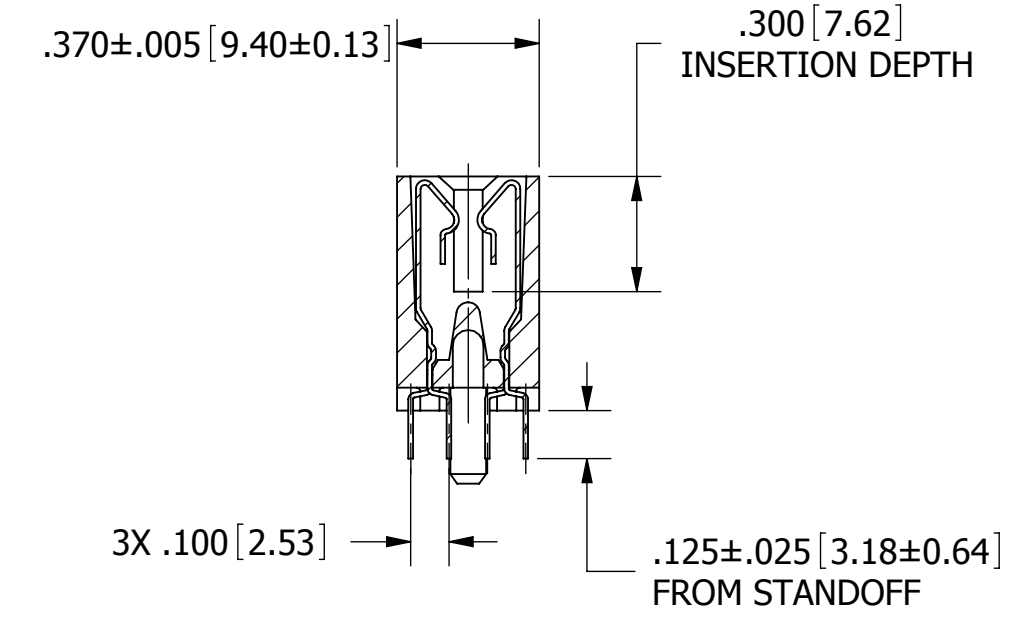
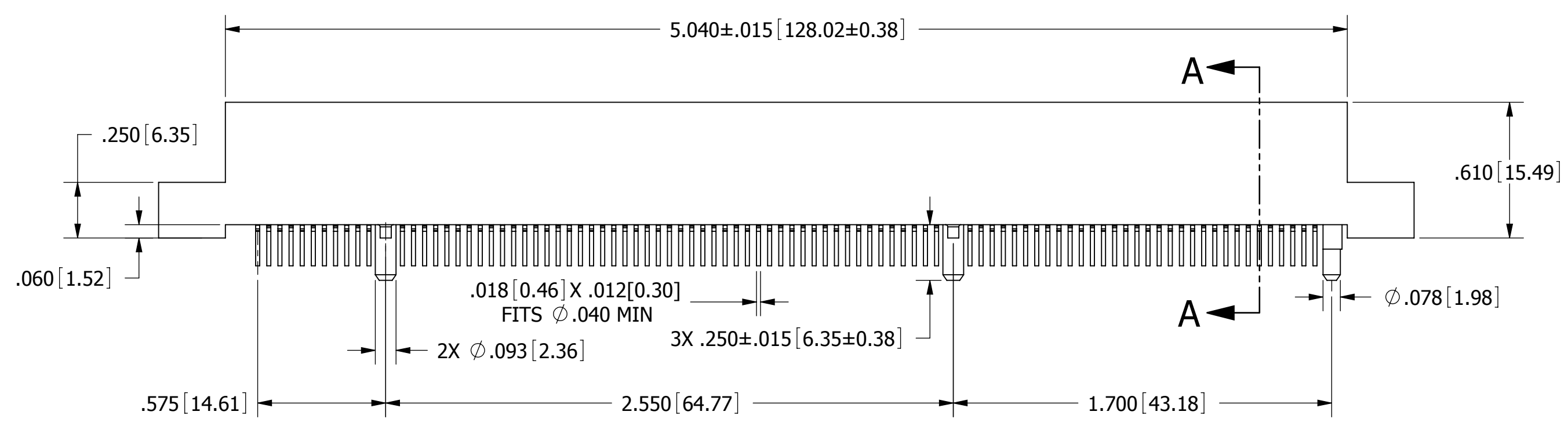
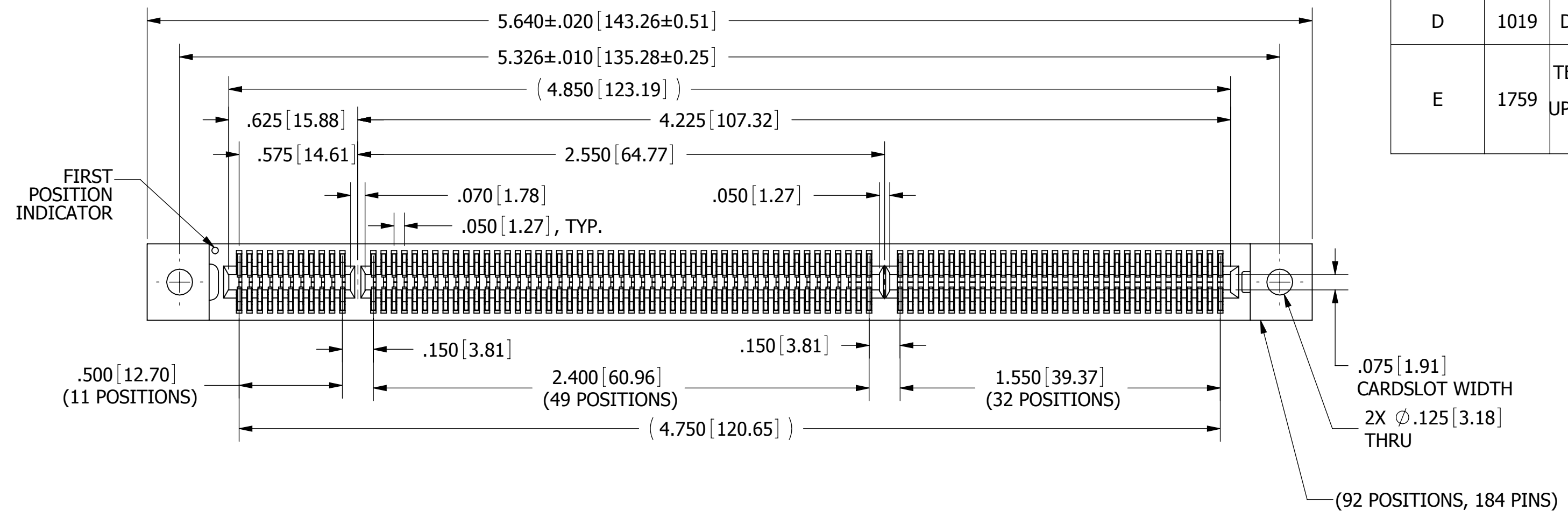

__ B92DHH - S330

SECTION A-A

- NOTES:
1. INSULATOR MATERIAL: SEE PART NUMBER CODING
 2. CONTACT MATERIAL: SEE PART NUMBER CODING
 3. PLATING: SEE PART NUMBER CODING
 4. TEMPERATURE: SEE PART NUMBER CODING
 5. PROCESSING TEMP: SEE PART NUMBER CODING
 6. UL FLAMMABILITY RATING: 94V-0
 7. VOLTAGE RATING: 250 VDC MINIMUM AT SEA LEVEL.
 8. CURRENT RATING: 1 AMP PER CONTACT
 9. CONTACT RESISTANCE: 30 MILLI OHM
 10. INSULATION RESISTANCE: 1000 MEGA OHM
 11. DURABILITY: 500 CYCLES MIN
 12. CONNECTOR IDENTIFICATION: THE PART SHALL BE MARKED WITH A PART NUMBER AND BARCODE
 13. BOARD THICKNESS ACCOMMODATED: $.062 \pm .008$ "
 14. BOARD INSERTION FORCE: 16 OZ MAX PER CONTACT PAIR WHEN USING A .062" TEST BLADE. INTERNAL INSPECTION TO BE PER SULLIN'S WORK INSTRUCTION W17.3-01.
 15. BOARD WITHDRAWAL FORCE: 1 OUNCE MINIMUM PER CONTACT PAIR USING .062" PCB
 16. MODIFICATION: CARDSLOT BARRIERS WITH GUIDEPOSTS, FOR PCI 64 BIT 3.3 VOLT 92 POSITION, 11/49/32.

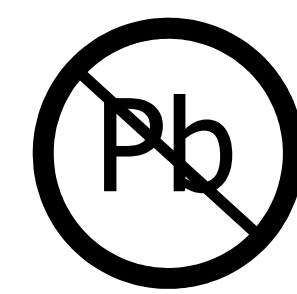

RoHS COMPLIANT

CUSTOMER COPY

UNLESS OTHERWISE SPECIFIED: DIMENSIONS ARE IN INCHES[MM] TOLERANCES: ANGULAR: $\pm 30^\circ$.XX = $\pm .02$ [.508] .XXX = $\pm .005$ [.1270] .XXXX = $\pm .0005$ [.0127] SURFACE FINISH: 63 Rq REMOVE ALL BURRS AND SHARP EDGES .010 MAX		DATE 01/27/05	NAME Aria, N	
<small>THE INFORMATION HEREIN CONTAINS PROPRIETARY INFORMATION OF SULLINS ELECTRONICS AND IS NOT TO BE REPRODUCED, USED OR DISCLOSED TO OTHERS FOR ANY PURPOSE EXCEPT AS SPECIFICALLY AUTHORIZED IN WRITING BY AN OFFICER OF SULLINS ELECTRONICS.</small>	DESCRIPTION EDGE CARD, .050 CC PART NUMBER B92DHH - S330			
INTERPRET DIMENSIONS AND GEOMETRIC TOLERANCING PER: ANSI Y14.5M-1994		SIZE C	DWG. NO. C10408	REV E
SCALE: 2:1		SHEET 1 OF 3		

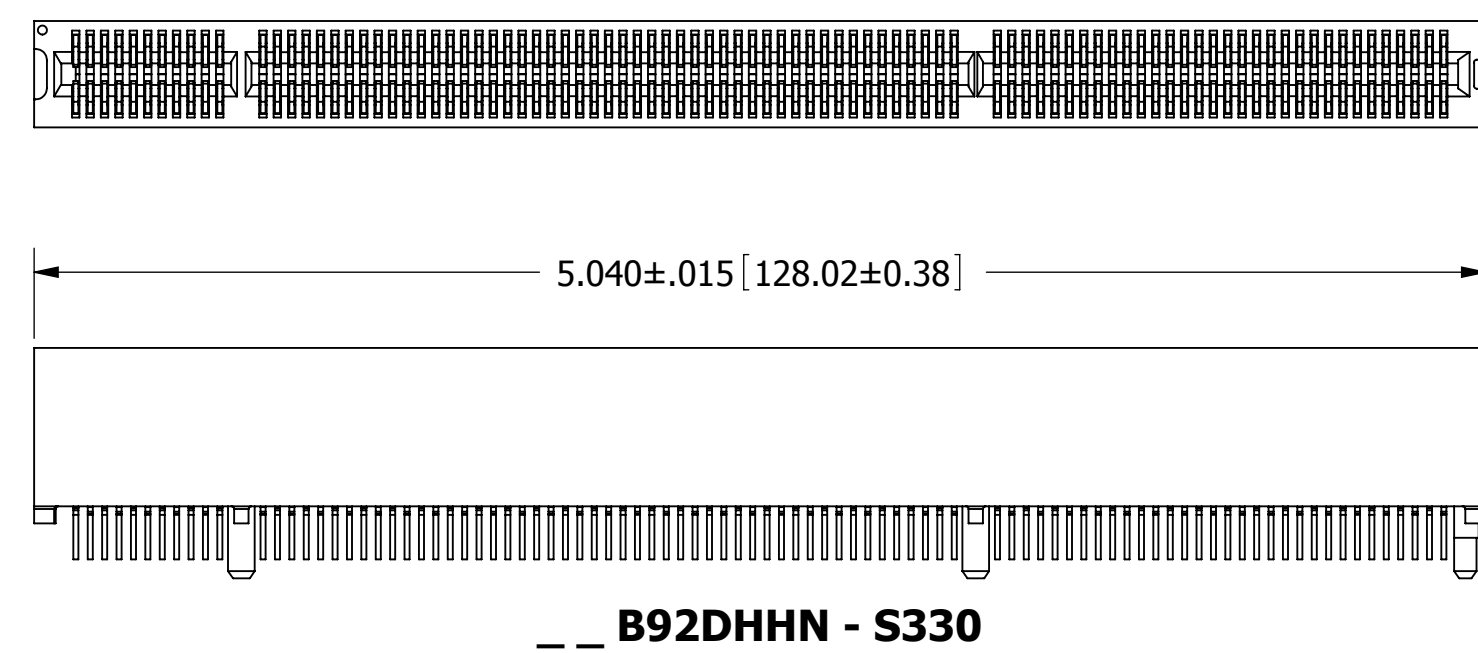
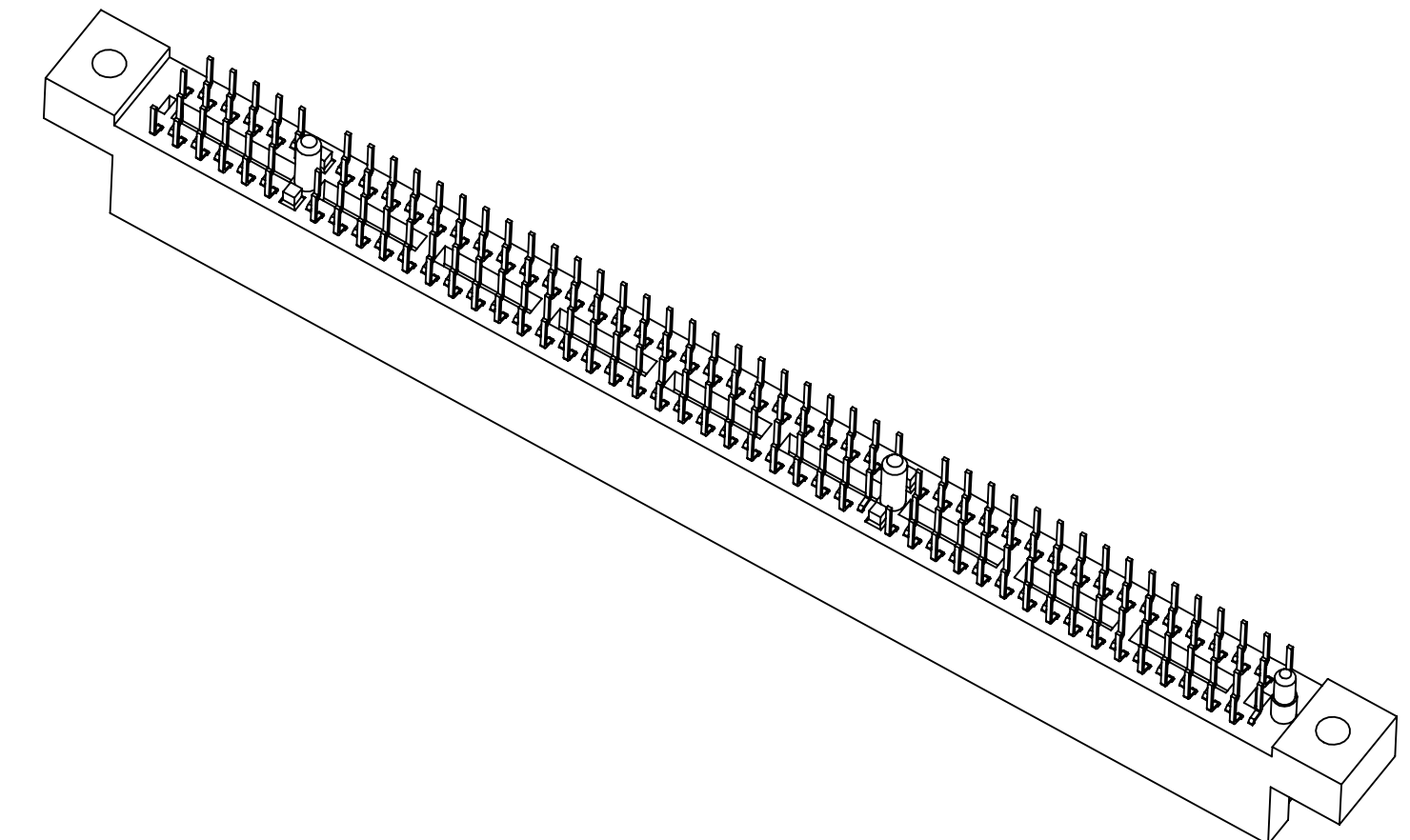
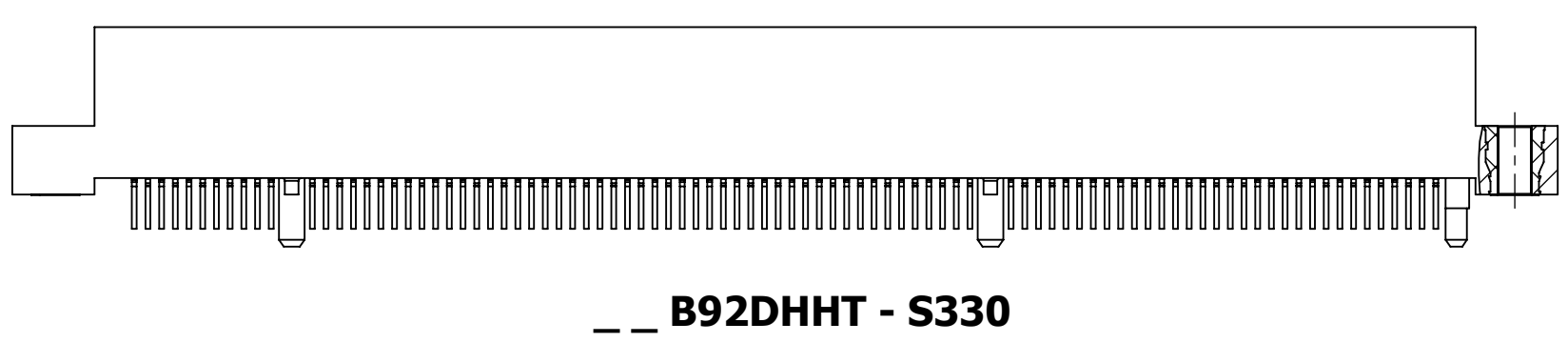
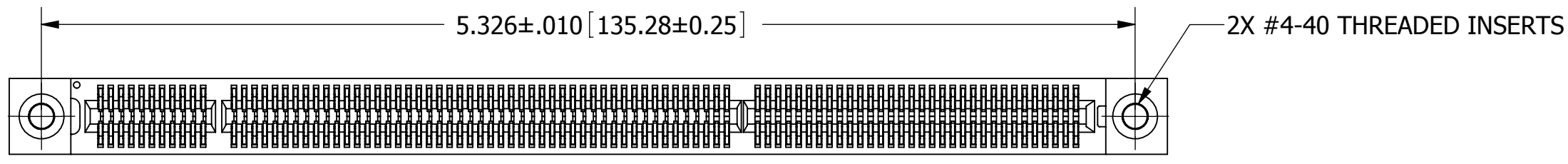

CUSTOMER COPY



UNLESS OTHERWISE SPECIFIED:
 DIMENSIONS ARE IN INCHES[MM]
 TOLERANCES:
 ANGULAR: ± 30'
 .XX=± .02 [.508]
 .XXX=± .005 [.1270]
 .XXXX=± .0005 [.0127]
 SURFACE FINISH: 63 Rc
 REMOVE ALL BURRS AND SHARP EDGES .010 MAX

INTERPRET DIMENSIONS AND GEOMETRIC TOLERANCING PER: ANSI Y14.5M-1994

DRAWN	01/27/05	DATE	Aria, N	NAME
<small>THE INFORMATION HEREIN CONTAINS PROPRIETARY INFORMATION OF SULLINS ELECTRONICS AND IS NOT TO BE REPRODUCED, USED OR DISCLOSED TO OTHERS FOR ANY PURPOSE EXCEPT AS SPECIFICALLY AUTHORIZED IN WRITING BY AN OFFICER OF SULLINS ELECTRONICS.</small>				
			EDGE CARD, .050 CC __ B92DHH - S330	
SIZE	DWG. NO.	REV		
C	C10408	E		
SCALE: 1.5:1			SHEET 2 OF 3	

PART NUMBER CODING

B92DHH - S330

MATERIAL (INSULATOR/CONTACT)

- R = PPS/PHOSPHOR BRONZE
OPERATING TEMP: -65°C TO +125°C
PROCESSING TEMP: 260° FOR 120 sec.MAX.
- G = PA9T/PHOSPHOR BRONZE
OPERATING TEMP: -65°C TO +125°C
PROCESSING TEMP: 260° FOR 120 sec.MAX.
- A = PPS/BERYLLIUM COPPER
OPERATING TEMP: -65°C TO +150°C
PROCESSING TEMP: 260° FOR 120 sec.MAX.
- J = PA9T/BERYLLIUM COPPER
OPERATING TEMP: -65°C TO +150°C
PROCESSING TEMP: 260° FOR 120 sec.MAX.

MOUNTING STYLE

- D = FLUSH MOUNTING (PAGE 1)
- N = NO MOUNTING (PAGE 2)
- T = FLUSH MOUNTING WITH #4-40 THREADED INSERT (PAGE 2)

PLATING

ALL PLATINGS ARE LEAD FREE AND HAVE .000050" NICKEL UNDERPLATE

- | | |
|------------------------|--------------------------|
| CONTACT SURFACE | TERMINATION |
| B = .000010" GOLD | .000100" PURE TIN, MATTE |
| C = .000030" GOLD | .000100" PURE TIN, MATTE |

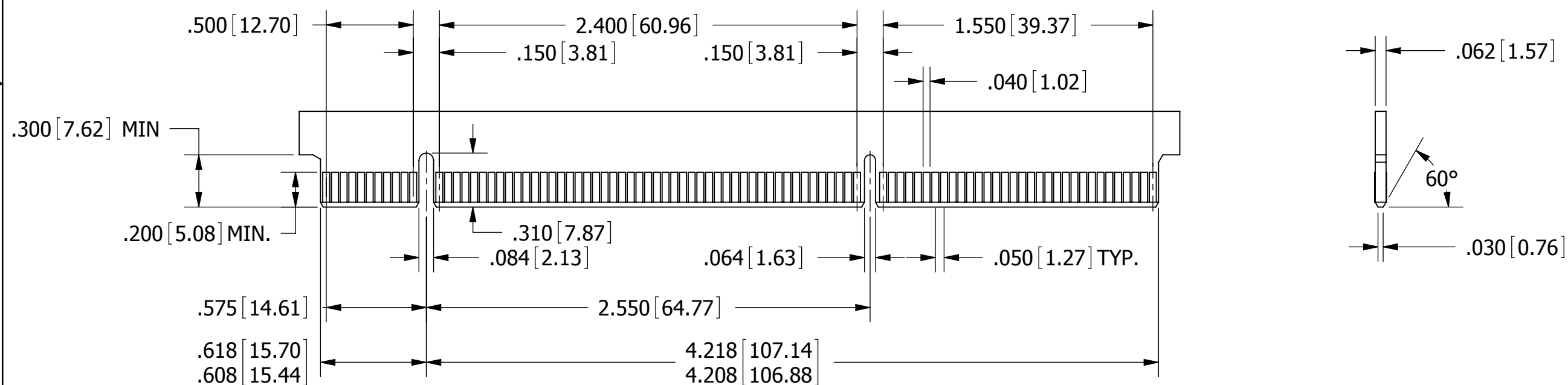

DAUGHTER CARD LAYOUT

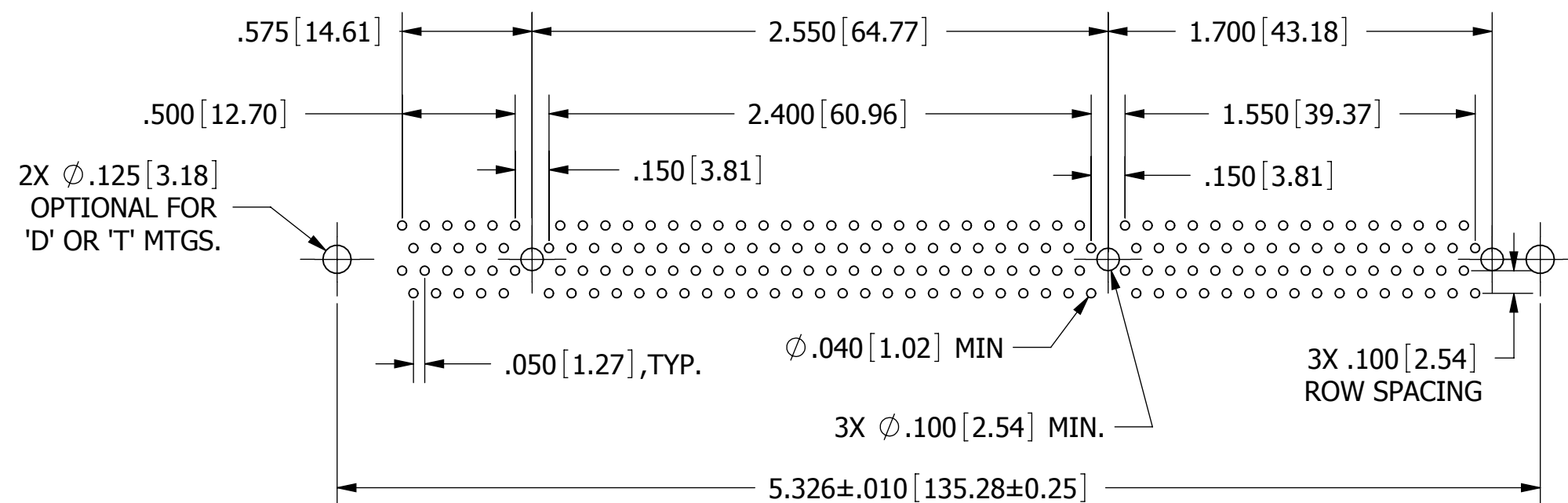

**PC BOARD LAYOUT
CONNECTOR SIDE**

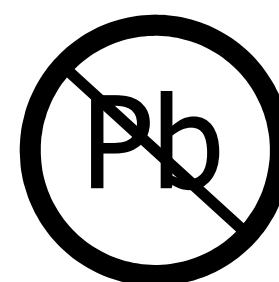

RoHS COMPLIANT

CUSTOMER COPY

UNLESS OTHERWISE SPECIFIED:
DIMENSIONS ARE IN INCHES[MM]
TOLERANCES:
ANGULAR: ± 30'
.XX=± .02 [.508]
.XXX=± .005 [.1270]
.XXXX=± .0005 [.0127]
SURFACE FINISH: 63 Rq
REMOVE ALL BURRS AND SHARP EDGES .010 MAX

INTERPRET DIMENSIONS AND GEOMETRIC TOLERANCING PER: ANSI Y14.5M-1994

DRAWN	DATE	NAME	
	01/27/05	Aria, N	
<small>THE INFORMATION HEREIN CONTAINS PROPRIETARY INFORMATION OF SULLINS ELECTRONICS AND IS NOT TO BE REPRODUCED, USED OR DISCLOSED TO OTHERS FOR ANY PURPOSE EXCEPT AS SPECIFICALLY AUTHORIZED IN WRITING BY AN OFFICER OF SULLINS ELECTRONICS.</small>			DESCRIPTION
			EDGE CARD, .050 CC
PART NUMBER			
B92DHH - S330			
SIZE	DWG. NO.	REV	
C	C10408	E	
SCALE: 1.5:1		SHEET 3 OF 3	